



**Waterville United Methodist Church**

# **New Facility Update**

**March 14, 2010**

*Lord, what do you want to do  
through me?*

# Today's Update

- **Present the Preliminary Building Concept**
- **Progress & actions in Finance area and forward plan**

# Building Committee

- **Your faith and commitment has made it possible to be here today**
- **Troyer has helped us turn dreams into designs**
- **This is our lighthouse to the community**
- **The result of many hours of effort by Troyer, the committee, and you**

# Introducing the Concept

- **This is the best overall design we could develop within our financial plan.**
- **We only have very rough, preliminary estimates now. Need actual bids to confirm costs.**
- **Virtually complete design, but we welcome your thoughts and ideas.**
- **Changes to the design beyond this point start to get more and more expensive.**

# Existing Site



# Conceptual Site Plan



See the separate video for an animation of the basic building concept.



# Phased Floor Plans

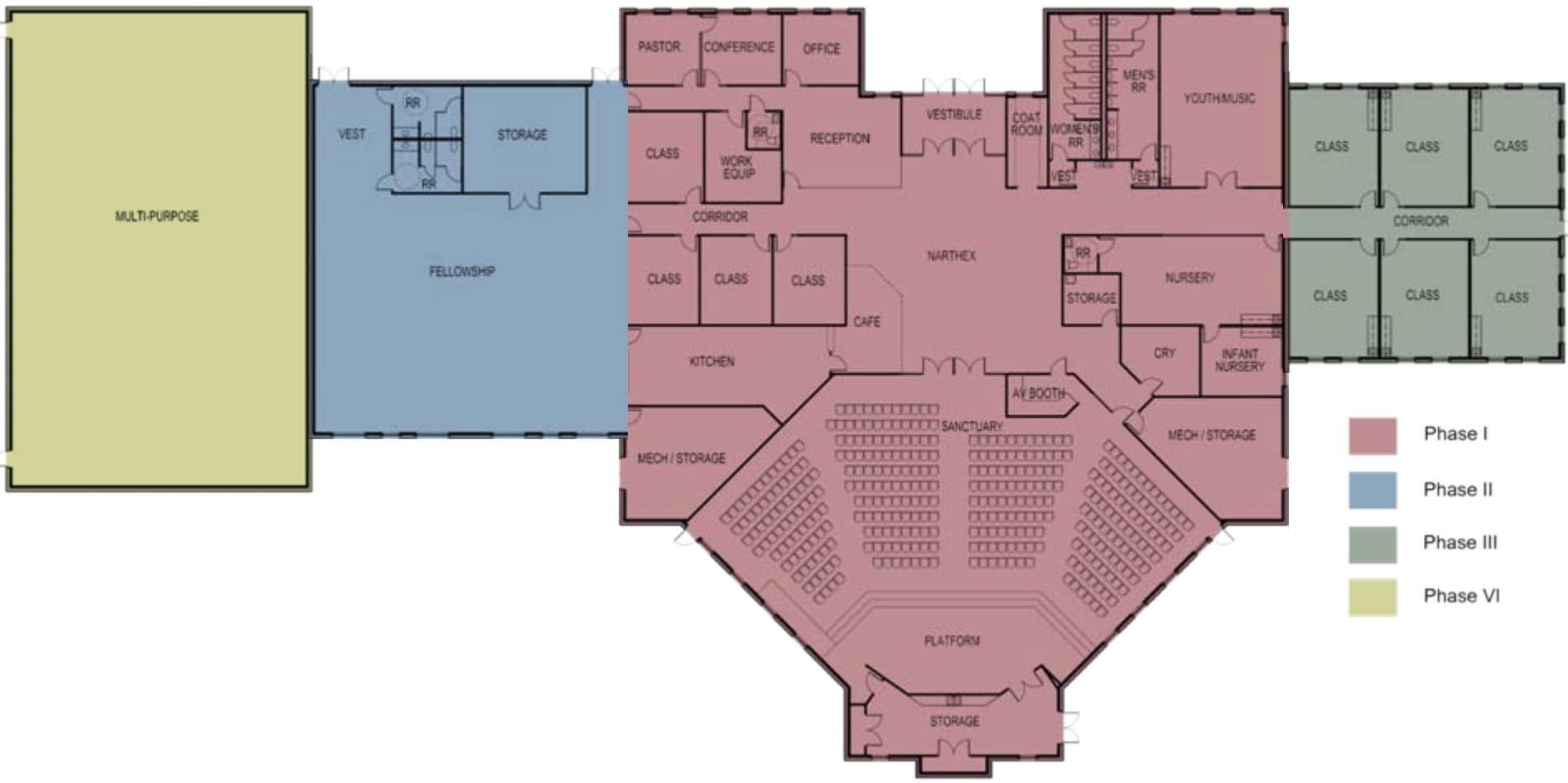

- Phase I
- Phase II
- Phase III
- Phase VI

Phase VI  
5,700 SF

Phase II  
4,410 SF

Phase I  
15,777 SF

Phase III  
2,952 SF



# Narthex – Interior Conceptual Perspective



# New Facility Phase 1 Funding

Shoemaker Memorial Fund-currently available	\$100,000
First Capital Campaign*, net of cost, to be completed in May 2011	634,000
Sale Of Parsonage (complete)	100,000
Second Capital Campaign-June 2011-May 2014	<u>550,000</u>
Total internal funds available	1,384,000
Mortgage loan-40% of total project	<u>916,000</u>
Total estimated Phase I cost	\$2,300,000

Note- Any proceeds from sale of current facility not included.

# New Facility Financial Plan

## Mortgage Payment Impact on Operating Budget

- Total amount borrowed: \$916,000
- Annual principal and interest payment at 7% for 20 year loan = \$85,220
- 2010 Operating Budget: \$270,662
- Increase to Operating Budget (20 year loan) = 31%
- Sensitivity to additional funds
  - Each \$100,000 reduction in the 20 year mortgage amount reduces the payment by \$9,304 per year or 3.5% of the operating budget

# Going Forward

- **2 or 3 small group sessions for those that weren't here today**
- **Troyer will complete and deliver drawings in May**
- **Your continued prayers, input, and financial support**



*Lord, what do you want to do  
through me?*